

MORSETTO A CAVALLOTTO ZINCATO - STAMPATO A CALDO

Corpo: Acciaio Fe 430 B

Cavallo: Acciaio Fe 360 B

CARFER

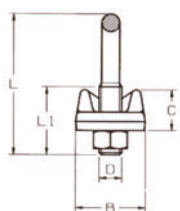
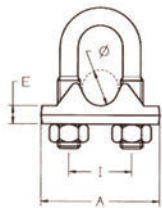

Codice	Misura	Fune	A	B	C	D	E	I	L	L1	Peso
	mm	mm	mm	mm	mm	mm	mm	mm	mm	mm	Kg
A15603	4	3-4	21	14	9	M 4	4,5	9	20	12	0,01
A15605	5	5	25	17	10	M 5	4,5	11	24	13	0,02
A15606	6	6	30	19	11	M 6	5	14,5	34	19	0,03
A15608	8	8	33	20	12	M 6	5,5	16	34	19	0,04
A15610	10	10	38	22	14	M 8	6	18	44	24	0,07
A15611	11	11	40	23	15	M 8	6,5	20	45	27	0,08
A15612	12	12	45	25	16	M 10	7	23	55	30	0,12
A15614	14	14	46	27	17	M 10	7,5	24	55	30	0,14
A15616	16	16	53	31	18	M 10	8	28	63	32	0,18
A15618	18	18	59	33	20	M 12	8	30	78	38	0,26
A15620	20	20	60	34	22	M 12	9	33	78	38	0,29
A15622	22	22	64	34	23	M 12	9,5	36	81	45	0,3
A15624	24	24-25	70	40	24	M 12	10	38	86	45	0,38
A15628	28	28	80	43	30	M 14	12	42	110	55	0,56
A15630	30	30	80	44,5	32	M 14	12	48	112	55	0,7
A15632	32	32	92	45	34	M 16	14	49	115	60	0,91
A15638	38	38-40	95	51	39	M 16	16	57	130	63	1,03
A15645	45	45	115	58	46	M 16	16	70	158	83	1,45
A15650	50	50	115	59	46	M 16	16	70	158	83	1,45

MORSETTO A CAVALLOTTO ZINCATO DIN 741

Corpo: Ghisa - Cavallo: Acciaio

CARFER

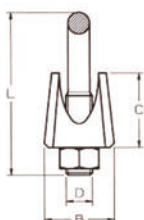
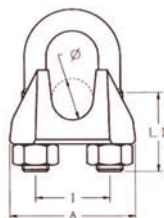

Codice	Misura	Fune	A	B	C	D	I	L	L1	Peso
	mm	mm	mm	mm	mm	mm	mm	mm	mm	Kg
A00303	3	3	21	10	10	M 4	9	20	12	0,008
A00305	5	5	24	11	10	M 5	11	24	13	0,01
A00306	6	6,5	26	12	11	M 5	13	28	15	0,02
A00308	8	8	30	14	15	M 6	16	34	19	0,03
A00310	10	10	37	20	19	M 8	20	42	22	0,05
A00311	11	11	38	20	20	M 8	21	44	22	0,06
A00312	12	13	44	25	23	M 10	25	55	30	0,11
A00314	14	14	46	25	25	M 10	27	57	30	0,13
A00316	16	16	52	28	28	M 12	30	63	33	0,15
A00320	20	19	58	32	34	M 12	34	75	38	0,23
A00322	22	22	64	35	35	M 14	38	85	44	0,27
A00326	26	26	68	38	38	M 14	42	95	45	0,3
A00330	30	30	80	40	45	M 16	50	110	50	0,5
A00332	32	32	80	40	45	M 16	50	118	50	0,65
A00334	34	34	88	45	52	M 16	54	120	55	0,68
A00340	40	40	95	48	58	M 16	60	140	60	0,86

MORSETTO ZINCATO UNI EN 13411-5

Corpo: Ghisa
Cavalotto: Acciaio

CARFER

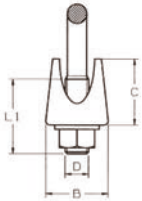
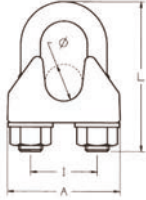

Codice	Misura	A	B	C	D	I	L	L1	Peso
	mm	mm	mm	mm	mm	mm	mm	mm	Kg
A00505B	5	25	13	13	M 5	12	25	13	0,02
A00506B	6,5	30	16	14	M 6	14	32	17	0,04
A00508B	8	39	20	18	M 8	18	41	20	0,08
A00510B	10	40	20	21	M 8	20	46	24	0,09
A00512B	12	50	24	25	M 10	24	50	28	0,25
A00514B	14	59	28	30	M 12	28	66	31	0,3
A00516B	16	64	32	35	M 14	32	76	35	0,43
A00519B	19	68	32	40	M 14	36	83	36	0,49
A00522B	22	74	34	44	M 16	40	96	40	0,68
A00526B	26	84	38	51	M 20	46	111	50	1,17
A00530B	30	95	41	59	M 20	54	127	55	1,4
A00534B	34	105	45	67	M 22	60	141	60	2,13
A00540B	40	117	49	77	M 24	68	159	65	2,68

TENDITORE A DUE OCCHI CORPO GHISA

Canala: Ghisa - Occhielli: Fe 430 B

CARFER

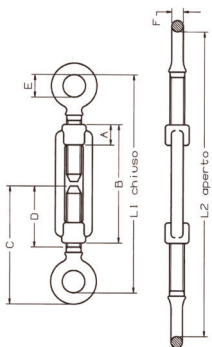

Codice	Misura	A	B	C	D	E	F	L1	L2	S.W.L.	Peso
		mm	mm	mm	mm	mm	mm	mm	mm	Kg	Kg
A15705	M 5	9	79	59	40	8	4	110	170	140	0,04
A15706	M 6	10	88	74	50	10	4	140	208	225	0,06
A15708	M 8	12	110	80	52	11	5	150	236	410	0,15
A15710	M 10	15	130	97	60	14	6,5	180	280	650	0,21
A15712	M 12	18	140	106	67	17	8	196	300	930	0,34
A15714	M 14	20	170	126	83	18	8,5	233	365	1330	0,5
A15716	M 16	22,5	190	160	97	23	13	294	440	1770	0,93
A15718	M 18	27	200	178	112	25	14	328	474	2200	1,38
A15720	M 20	30	220	190	116	25	14	352	510	2700	1,42
A15722	M 22	33	242	200	120	30	16	368	544	3300	2,11
A15724	M 24	39	255	210	125	34	17	386	563	3920	2,76